

# Tristel Jet

## **Sporicidal disinfectant gel for surfaces**

User Guide



**JET IS AVAILABLE IN FRAGRANCED  
OR UN-FRAGRANCED FORMATS**

## TRISTEL JET FOR SURFACES

**Chlorine dioxide in a gel: nothing is more effective!**

Tristel Jet for Surfaces is Tristel's latest product for surface disinfection. It is a sporicidal disinfectant which kills *Clostridium difficile* spores, MRSA, TB, viruses including swine flu and other pathogenic organisms. Jet is chlorine dioxide in a gel, easy and ready to use and non-hazardous due to the non-aerosol technology.

According to The National Patient Safety Agency Healthcare Cleaning Manual June 2009, Infection Control Overview, "The essence of good cleaning is that things not only look clean afterwards, but that they are clean. All users of healthcare premises have a right to assume that the environment is one where infection hazards are adequately controlled". Tristel Jet for surfaces will enable the user to comply with this. It is ideal for near patient surfaces because its gel formulation can be applied without risk to the patient.

### FEATURES

- Gel formulation for accurate application
- Sporicidal within 30 seconds
- Safe non-aerosol technology
- Available in a fragranced (faint smell of lemon) or an un-fragranced (faint smell of chlorine) format.

### APPLICATIONS

- Commodes
- Mattresses
- Near patient surfaces
- Dressing trolleys
- General ward cleaning
- Patient hoists
- Other hard surfaces



The Jet is a sophisticated re-usable applicator for chlorine dioxide gel. The Jet can be disinfected using Tristel Fuse.

The Pack consists of:

1. One bottle containing sodium chlorite solution
2. One bottle containing a synergistic organic acid blend.

Both solutions are in gel form.

Once assembled, the Jet Pack is ready to use on hard surfaces within the medical area as listed in the above applications.

## HOW TO ASSEMBLE THE JET PACK



Take one Jet and one Pack to assemble the Jet Pack. Remove both bottle caps from the Pack.



Place the Jet into the Pack by inserting the tube into the open bottle neck.

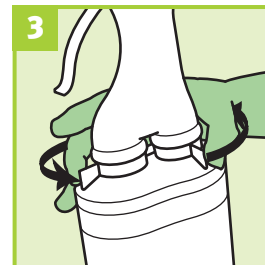

Attach the Jet to the Pack by fastening the levers on each side.

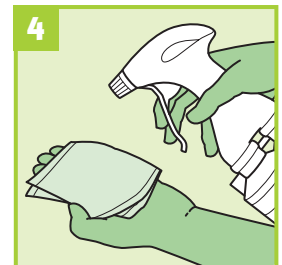

The Jet Pack is now ready to be used. The gel can either be applied onto a cloth, or directly onto the surface.



When empty, dispose of the bottle Pack and re-use the Jet for the next Jet Pack.



**Accurate application with no aerosol**

**Additional Information:**

- Store in original containers in a cool, well ventilated area out of direct sunlight.
- Dispose of empty packaging in accordance with local policy and national regulations.
- Avoid contact with skin and eyes. Contact with the disinfectant may cause mild irritation. Wash affected areas with plenty of soap and water.
- For professional use only.

**Manufactured by:**

Tristel Solutions Limited  
CB8 7NY, UK

**Tel:** +44 (0)1638 721500

**Fax:** +44 (0)1638 721911

**Email:** mail@tristel.com

**Web:** www.tristel.com